



Manual

HEADER TRANSPORT

OPERATOR'S MANUAL

| | |
|-------|-------------|
| MODEL | HT-974 |
| | HT-974L-30 |
| | HT-974XL-36 |
| | HT-974-20 |

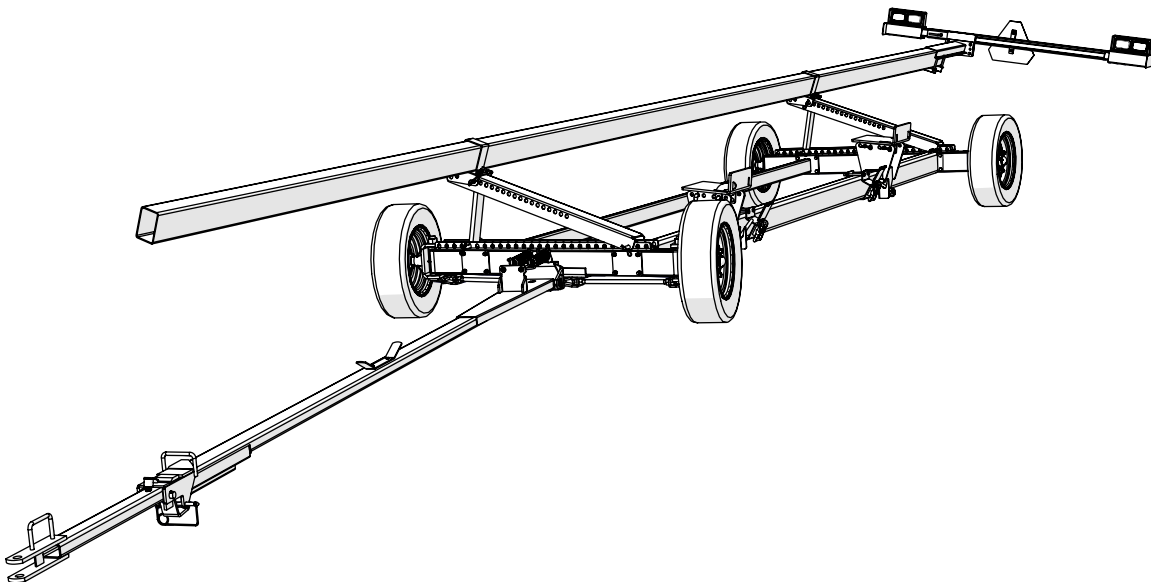

Rev. 9.9.2024

J&M Manufacturing Co, Inc

284 Railroad Street - P.O. Box 547 | Fort Recovery, OH 45846 | Ph: (419) 375-2376 | Fax: (419) 375-2708

www.jm-inc.com

Table of Contents

| | |
|--|----|
| General Information | 4 |
| Safety Rules..... | 4 |
| Bolt Torque Chart | 5 |
| Stud and Wheel Nut Torque Specifications | 5 |
| Specs and Dimensions | 6 |
| Initial Operation/Maintenance..... | 7 |
| Service | 8 |
| Repair Parts List and Diagrams | |
| Decals | 9 |
| Spindle & Tire Assemblies | 10 |
| Main Frame & Bars | 11 |
| Tongue Assembly | 12 |
| Header Mounts and Straps | 14 |
| Upper Bar Mounts | 16 |
| Axle Weldments | 17 |
| Lights and Wiring for Pivoting Lightbar No Brakes..... | 19 |

To the Dealer

Read manual instructions and safety rules. Make sure all items on the Dealer's Pre-Delivery and Delivery Check Lists are completed before releasing equipment to the owner.

The dealer must complete the Warranty Registration found on the Dealer Portal website located at dealer.jm-inc.com and return it to J&M Mfg. Co., Inc. at the address indicated on the form. Warranty claims will be denied if the Warranty Registration has not been submitted.

EXPRESS WARRANTY:

J&M Mfg. Co., Inc. warrants against defects in construction or materials for a period of ONE year. We reserve the right to inspect and decide whether material or construction was faulty or whether abuse or accident voids our guarantee.

Warranty service must be performed by a dealer or service center authorized by J&M Mfg. Co., Inc. to sell and/or service the type of product involved, which will use only new or remanufactured parts or components furnished by J&M Mfg. Co., Inc. Warranty service will be performed without charge to the purchaser for parts or labor based on the Warranty Labor Times schedule. Under no circumstance will allowable labor times extend beyond the maximum hours indicated in the Warranty Labor Times schedule for each warranty procedure. The purchaser will be responsible, however, for any service call and/or transportation of the product to and from the dealer or service center's place of business, for any premium charged for overtime labor requested by the purchaser, and for any service and/or maintenance not directly related to any defect covered under the warranty. Costs associated with equipment rental, product down time, or product disposal are not warrantable and will not be accepted under any circumstance.

Each Warranty term begins on the date of product delivery to the purchaser. Under no circumstance will warranty be approved unless (i) the product warranty registration card has been properly completed and submitted to the equipment manufacturer, and (ii) a warranty authorization number has been issued by the equipment manufacturer. This Warranty is effective only if the warranty registration card is returned within 30 days of purchase.

This Warranty does not cover a component which fails, malfunctions or is damaged as a result of (i) improper modification or repair, (ii) accident, abuse or improper use, (iii) improper or insufficient maintenance, or (iv) normal wear or tear. This Warranty does not cover products that are previously owned and extends solely to the original purchaser of the product. Should the original purchaser sell or otherwise transfer this product to a third party, this Warranty does not transfer to the third party purchaser in any way. J&M Mfg. Co., Inc. makes no Warranty, express or implied, with respect to tires or other parts or accessories not manufactured by J&M Mfg. Co., Inc. Warranties for these items, if any, are provided separately by their respective manufacturers.

THIS WARRANTY IS EXPRESSLY IN LIEU OF ALL OTHER WARRANTIES OR CONDITIONS, EXPRESS, IMPLIED OR STATUTORY, INCLUDING ANY IMPLIED WARRANTY OF MERCHANTABILITY OR FITNESS FOR PARTICULAR PURPOSE.

In no event shall J&M Mfg. Co., Inc. be liable for special, direct, incidental or consequential damages of any kind. The exclusive remedy under this Warranty shall be repair or replacement of the defective component at J&M Mfg. Co., Inc.'s option. This is the entire agreement between J&M Mfg. Co., Inc. and the Owner about warranty and no J&M Mfg. Co., Inc. employee or dealer is authorized to make any additional warranty on behalf of J&M Mfg. Co., Inc.

The manufacturer reserves the right to make product design and material changes at any time without notice. They shall not incur any obligation or liability to incorporate such changes and improvements in products previously sold to any customer, nor shall they be obligated or liable for the replacement of previously sold products with products or parts incorporating such changes.

SERVICE:

The equipment you have purchased has been carefully manufactured to provide dependable and satisfactory use. Like all mechanical products, it will require cleaning and maintenance. Lubricate the unit as specified. Observe all safety information in this manual and safety signs on the equipment.

For service, your authorized J&M dealer has trained mechanics, genuine J&M service parts, and the necessary tools and equipment to handle all your needs.

Use only genuine J&M service parts. Substitute parts may void warranty and may not meet standards required for safety and satisfactory operation. Record the model number and serial number of your equipment in the spaces provided:

Model No: HT-974 Header Wagon **Serial No:** _____ **Date of Purchase:** _____

Purchased From: _____

Provide this information to your dealer to obtain correct repair parts.

Serial Number Location

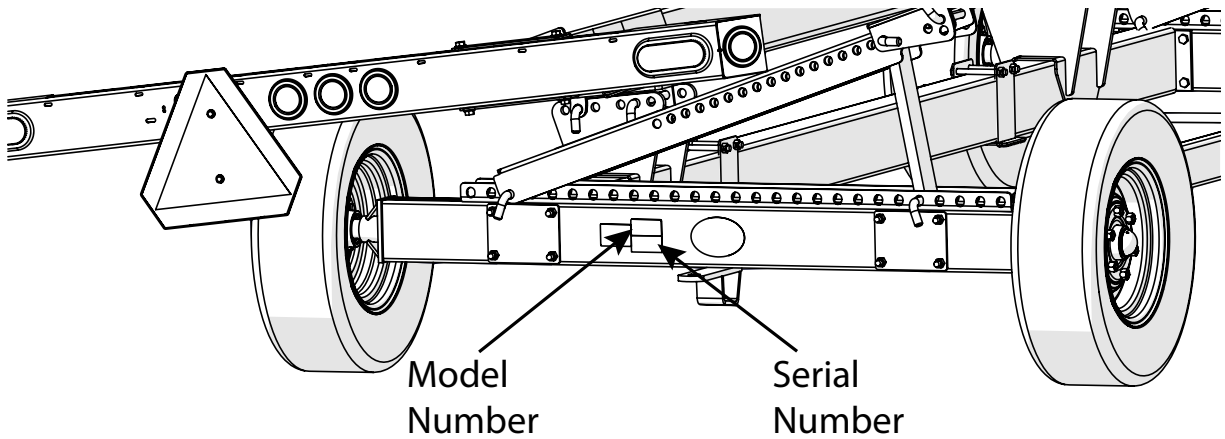

Serial Number: _____

Model Number: _____

Standard practice when ordering parts or obtaining information from your dealer requires the serial number and model number. Have numbers available before making contact.

General Information

TO THE OWNER:

The purpose of this manual is to assist you in operating and maintaining your header transport in a safe manner. Read it carefully. It furnishes information and instructions that will help you achieve years of dependable performance and help maintain safe operating conditions. If this machine is used by an employee or is loaned or rented, make certain that the operator(s), prior to operating:

1. Is instructed in safe and proper use.
2. Reviews and understands the manual(s) pertaining to this machine.

Throughout this manual, the term **IMPORTANT** is used to indicate that failure to observe can cause damage to equipment. The terms **CAUTION**, **WARNING** and **DANGER** are used in conjunction with the Safety-Alert Symbol (a triangle with an exclamation mark) to indicate the degree of hazard for items of personal safety. When you see this symbol, carefully read the message that follows and be alert to the possibility of personal injury or death.



This Safety-Alert symbol indicates a hazard and means **ATTENTION! BECOME ALERT! YOUR SAFETY IS INVOLVED!**



DANGER

Indicates an imminently hazardous situation that, if not avoided, will result in death or serious injury.



WARNING

Indicates a potentially hazardous situation that, if not avoided, could result in death or serious injury, and includes hazards that are exposed when guards are removed.



CAUTION

Indicates a potentially hazardous situation that, if not avoided, may result in minor or moderate injury.

IMPORTANT

Indicates that failure to observe can cause damage to equipment.

NOTE

Indicates helpful information.

Safety Rules

ATTENTION! BECOME ALERT! YOUR SAFETY IS INVOLVED!

Safety is a primary concern in the design and manufacture of our products. Unfortunately, our efforts to provide safe equipment can be erased by an operator's single careless act. In addition, hazard control and accident prevention are dependent upon the awareness, concern, judgment, and proper training of personnel involved in the operation, transport, maintenance and storage of equipment.

Make certain that the operator(s), prior to operating is instructed in safe and proper use and reviews and understands the manual(s) pertaining to this machine.

Read this manual before you operate this machine. If you do not understand any part of this manual, or need more information, contact the manufacturer or your authorized dealer.

SAFETY

Understand that your safety and the safety of other persons is measured by how you service and operate this machine. Know the positions and functions of all controls before you try to operate them. Make sure to check all controls in a safe area before starting your work.

The safety information given in this manual does not replace safety codes, federal, state or local laws. Make certain your machine has the proper equipment as designated by local laws and regulations.

A frequent cause of personal injury or death is from persons falling off equipment and being run over. Do not permit persons to ride on this machine.

Travel speeds should be such that complete control and machine stability is maintained at all times. Where possible, avoid operating near ditches, embankments and holes. Reduce speed when turning, crossing slopes and rough, slick or muddy surfaces.

Collision of high speed road traffic and slow moving machines can cause personal injury or death. On roads, use flasher lights according to local laws. Keep slow-moving-vehicle emblem visible. Pull over to let faster traffic pass.

Make sure that the header is fastened securely to the transport before moving.

Make sure that everyone is clear of equipment before applying power or moving the machine. NEVER position yourself under or near header when mounting on the header transport.

Make sure that the implement is fastened securely to the towing unit by using the proper hitch pin, clip and safety chains.

Before unhooking the implement from the towing unit, be sure to properly block the wheels to prevent the implement from moving.

Never overload the header transport. Overloading the header transport is dangerous and can cause extensive damage.

Do NOT exceed speeds in excess of 25 MPH. The header transport is designed for heavy loads at slow speeds. Also be sure slow moving vehicle emblem is attached to rear of wagon.

IMPORTANT: Use caution when transporting. Be alert of the transport unit's overall width when approaching obstacles, such as post signs and poles, along the road. Check the transport width of the unit to ensure clearance before entering bridges.

COMPLY WITH ALL SAFETY WARNINGS AND CAUTIONS IN THIS MANUAL AND IN THE COMBINE OPERATOR'S MANUAL.

WARNING: BE SURE ALL LIGHTS ARE WORKING PROPERLY BEFORE ROAD TRAVEL.

Bolt Torque Chart

Always tighten hardware to these values unless a different torque or tightening procedure is listed for specific application. Fasteners must always be replaced with the same grade as specified in the manual parts list. Always use the proper tool for tightening hardware. Make sure fastener threads are clean and you start thread engagement properly. **Use these values when tightening all bolts and nuts with the exception of wheel nuts.**

SAE Fasteners

| Coarse Thread Series | | | | |
|-----------------------------|-----------|----------|-----------|-----------|
| Diameter and Pitch (Inches) | Grade 5 | | Grade 8 | |
| | Dry | Oiled | Dry | Oiled |
| 1/4"-20 | 8 ft-lbs | 6 ft-lbs | 12 ft-lbs | 9 ft-lbs |
| 5/16"-18 | 17 | 13 | 25 | 18 |
| 3/8"-16 | 31 | 23 | 44 | 33 |
| 7/16"-14 | 49 | 37 | 70 | 52 |
| 1/2"-13 | 75 | 57 | 106 | 80 |
| 9/16"-12 | 109 | 82 | 154 | 115 |
| 5/8"-11 | 150 | 113 | 212 | 159 |
| 3/4"-10 | 267 | 200 | 376 | 282 |
| 7/8"-9 | 429 | 322 | 606 | 455 |
| 1"-8 | 644 | 483 | 909 | 681 |
| Fine Thread Series | | | | |
| Diameter and Pitch (Inches) | Grade 5 | | Grade 8 | |
| | Dry | Oiled | Dry | Oiled |
| 1/4"-28 | 10 ft-lbs | 7 ft-lbs | 14 ft-lbs | 10 ft-lbs |
| 5/16"-24 | 19 | 15 | 27 | 20 |
| 3/8"-24 | 35 | 26 | 49 | 37 |
| 7/16"-20 | 55 | 41 | 78 | 58 |
| 1/2"-20 | 85 | 64 | 120 | 90 |
| 9/16"-18 | 121 | 91 | 171 | 128 |
| 5/8"-18 | 170 | 127 | 240 | 180 |
| 3/4"-16 | 297 | 223 | 420 | 315 |
| 7/8"-14 | 474 | 355 | 669 | 502 |

Stud and Wheel Nut Torque Specifications

Always tighten hardware to these values unless a different torque or tightening procedure is listed for specific application. Fasteners must always be replaced with the same grade as specified in the manual parts list. Always use the proper tool for tightening hardware. Make sure fastener threads are clean and you start thread engagement properly. **Use these values when tightening all studs and wheel nuts.**

| Stud | Tightening Torque |
|----------|-------------------|
| 1/2"-20 | 120 ft-lbs |
| 9/16"-18 | 170 ft-lbs |
| 5/8"-18 | 300 ft-lbs |
| 3/4"-16 | 400 ft-lbs |
| 20mm | 475 ft-lbs |
| 22mm | 640 ft-lbs |

TIGHTENING WHEEL NUTS: Standard **1/2" wheel studs and nuts should be tightened to torque 120 ft-lbs.** During initial operation of the header transport and then checked for proper torque after every 10 hours of use. Failure to do so may damage wheel nut seats. Once seats are damaged, it will become impossible to keep nuts tight.

Specs and Dimensions

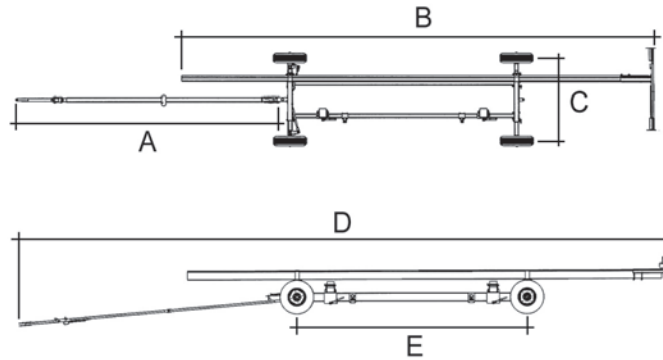

| Dimensions | | | | |
|------------|---------|------------|-------------|-----------|
| | HT-974 | HT-974L-30 | HT-974XL-36 | HT-974-20 |
| A | 12'-0" | 15'-0" | 17'-0" | 6'-2" |
| B | 27'-0" | 32'-0" | 38'-0" | 20'-5" |
| C | 6'-2" | 6'-2" | 6'-2" | 6'-2" |
| D | 33'-6" | 39'-9" | 44'-9" | 27'-1" |
| E | 13'-10" | 16'-6" | 16'-6" | 18'-4" |

| Specifications | | | | |
|------------------------|-----------------|-----------------|-----------------|-----------------|
| | HT-974 | HT-974L-30 | HT-974XL-36 | HT-974-20 |
| Weight | 1,540 lbs | 1,755 lbs | 1,830 lbs | 1,725 lbs |
| Capacity (Net) | 7,500 lbs | 10,700 lbs | 10,620 lbs | 11,000 lbs |
| Spindle Size | 1-3/4" Diameter | 1-3/4" Diameter | 1-3/4" Diameter | 1-3/4" Diameter |
| Wheel Size | 14"x6"-6 Bolt | 15"x6"-6 Bolt | 15"x6"-6 Bolt | 15"x6"-6 Bolt |
| Tire Size | 215/75R14-D | 225/75R15-E | 225/75R15-E | 225/75R15-E |
| Steel Upper Bar | 4"x6" | 4"x6" | 4"x6" | 4"x6" |
| Upper Bar Length | 25' | 30' | 36' | 20' |
| Box Channel Axle Frame | 6" | 6" | 6" | 6" |

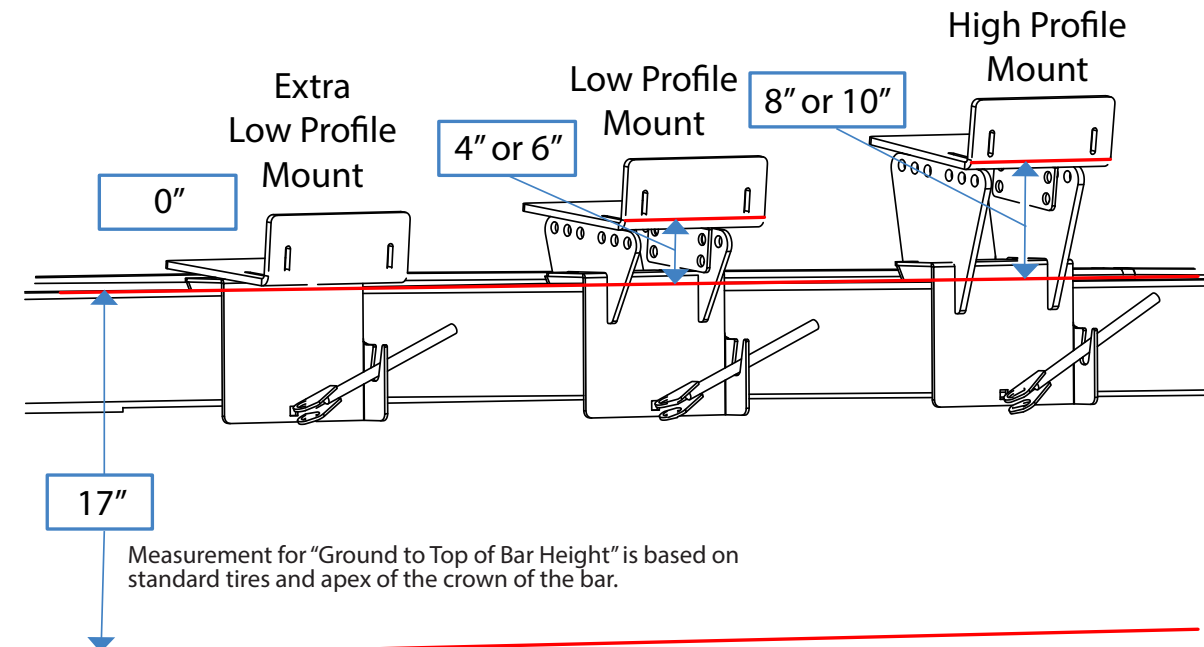

Initial Operation/Maintenance

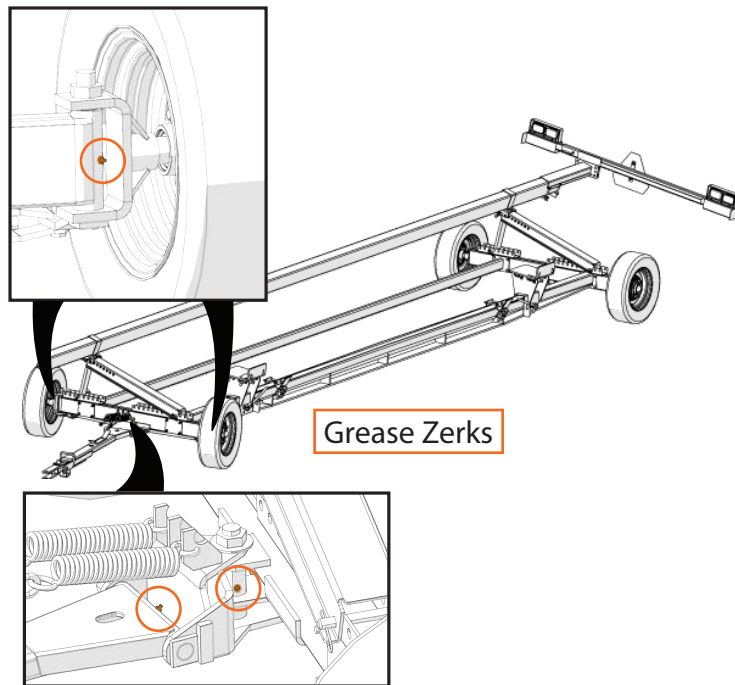

INITIAL OPERATION / MAINTENANCE

BE CERTAIN THAT ALL POWER IS SHUT OFF BEFORE SERVICING THE HEADER TRANSPORT

Before the header transport is put into service:

- Has the Slow-Moving Vehicle Emblem been properly positioned at the rear of the header transport?
- Have all danger, warning, caution and important signs on the equipment been read and understood? If employees or others use or are near this equipment, make sure that they also have read and understood all danger, warning, caution, and important signs on the equipment and have also read the operators manual.
- Are all braces, bolts, nuts, lug bolts and lug nuts properly fastened?
- Has the header transport been properly fastened to the towing unit? Use a good quality hitch pin with clip and safety chains.

OPERATING INSTRUCTIONS/ MAINTENANCE

- Adjust the brackets on the header transport to best fit your make and model header. When mounting the header, NEVER position yourself under or near the header.
- Do not exceed the load and size limits of the unit.
- Keep the tires properly inflated. Both under inflation and over inflation can greatly reduce tire life.
- Inspect bracing and welds periodically and repair immediately if needed. Failure to repair could cause extensive damage and greatly reduce the life of the unit.
- Repack the bearings in the hub assembly once a year or as needed. Use a good quality bearing lubricant such as Bearing Guard MK1 or equivalent.
- Insert the amount of grease needed into all of the grease zerks shown in the image above.
- Be sure to check the hub nuts often and keep them properly tightened.
- Check alignment of tires yearly. Adjust the push pull bar to realign the tires if needed.

Always Position Knee Brace For Optimal Load-Bearing Support



Service

Adjusting the Wheel Toe-In

1. Locate the tongue in the straight and horizontal position. Check this by measuring reference lines "A" and "B". These measurements are the same when the tongue is straight forward.
2. To adjust the toe-in of the tire on the front axle, measure the distance between the wheels at the centerline of the tires. Dimension "C" should be 1/8" to 1/4" shorter than dimension "D". If not, loosen the locknuts on both ends of both front tie rods. Adjust both front tie rods evenly as needed. Re-tighten the locknuts and recheck the dimensions.

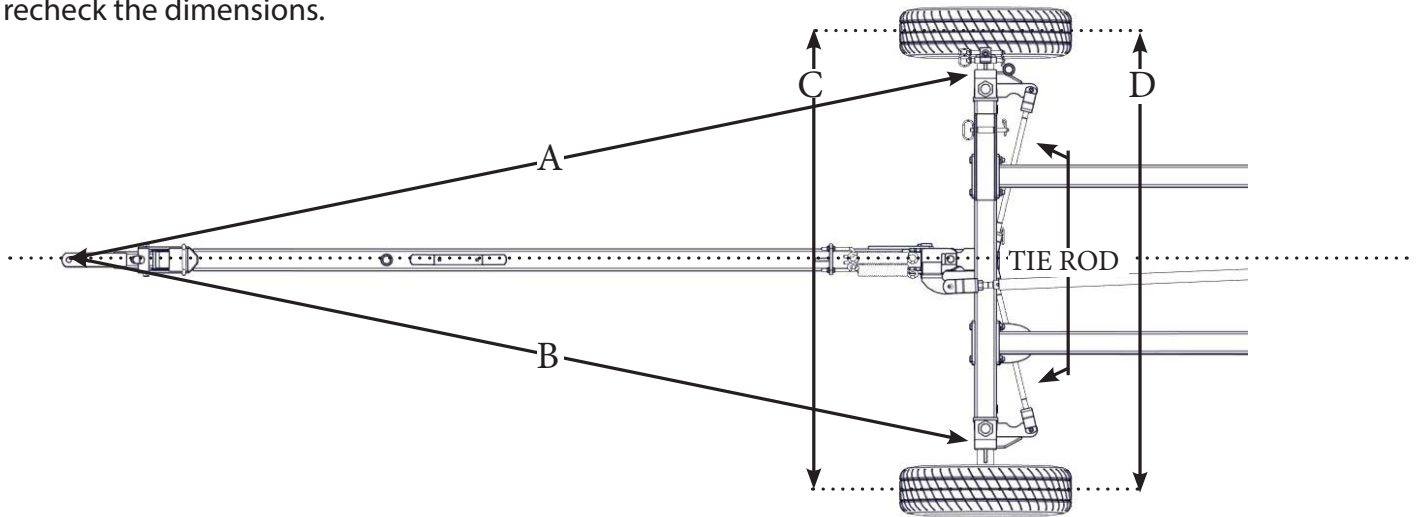

Repair Parts List and Diagrams

When performing maintenance work, wear sturdy, rough-soled work shoes and protective equipment for eyes, hair, hands, hearing and head. Follow the Operator's Manual instructions to ensure safe and proper maintenance and repair.

Your local, authorized dealer can supply genuine replacement parts. Substitute parts may not meet original equipment specifications and may be dangerous.

⚠ WARNING MAKE SURE ALL POWER IS SHUT OFF BEFORE PERFORMING ANY MAINTENANCE OR REPAIR WORK.

Decals

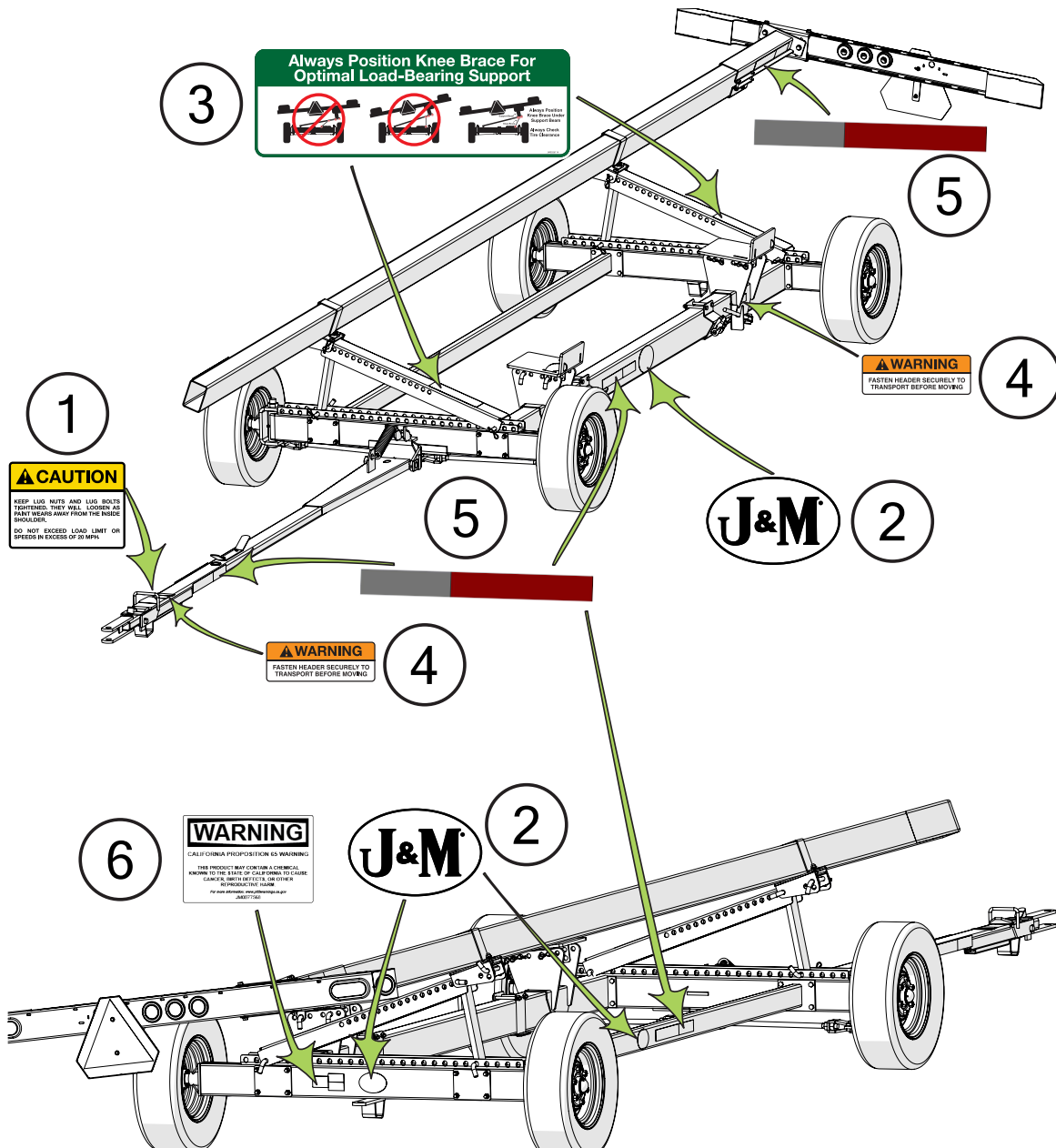

| Description | Part No. |
|---|-----------|
| 1 Caution, Keep Lug Nuts and Lug Bolts Tightened Decal | JM0019220 |
| 2 J&M Oval Decal (Small) 3-5/8" x 5-1/4" | JM0015150 |
| 3 HT - Knee Brace Set Up Decal | JM0026114 |
| 4 Warning - Fasten Header Securely To Transport Before Moving Decal | JM0039381 |
| 5 2" x 18" Red and White Reflective Strip | JM0015079 |
| 6 California Proposition 65 Warning Decal | JM0077568 |

Spindle & Tire Assemblies

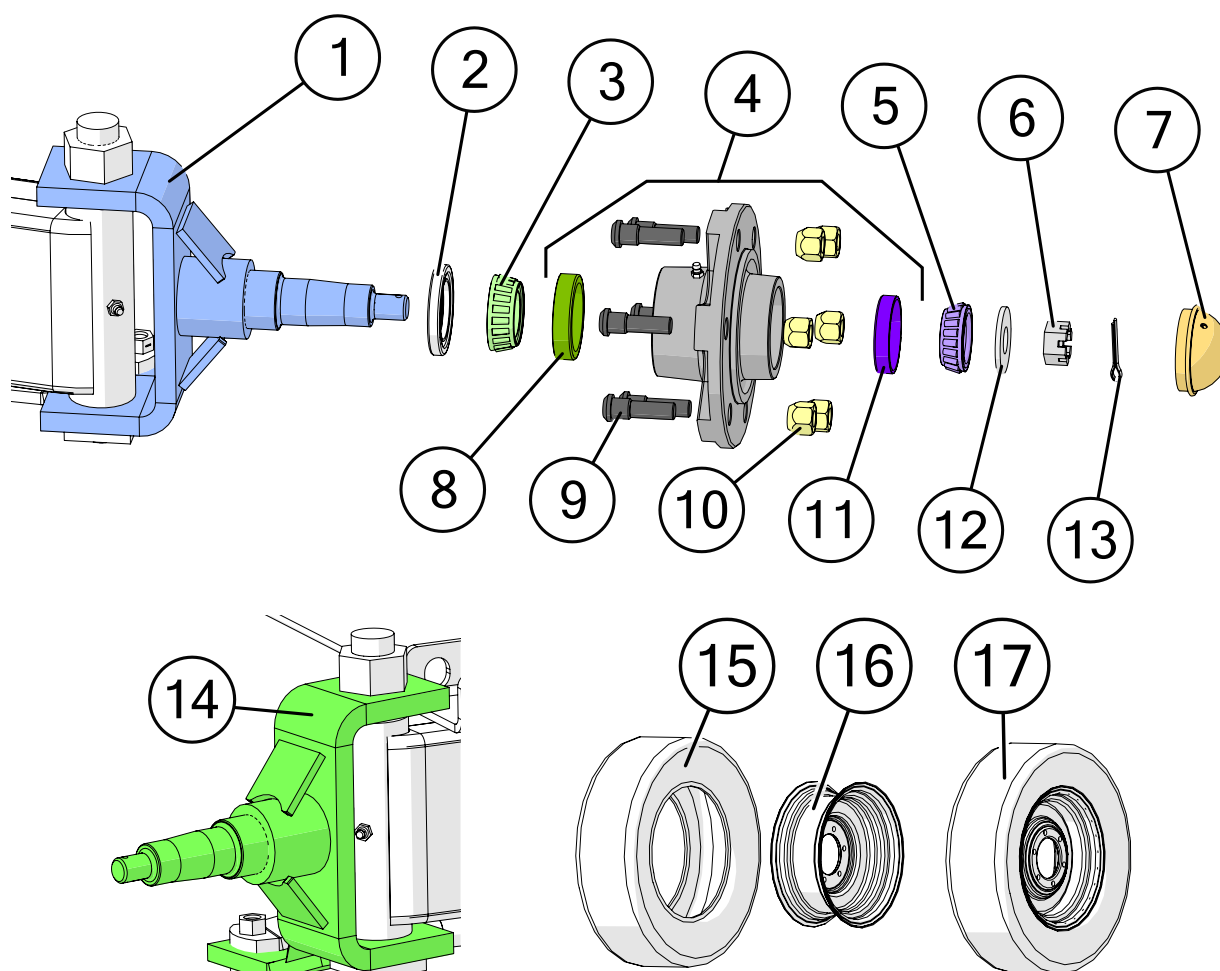

| | Description | Part No. |
|----|---|-----------|
| 1 | 1-3/4" Spindle & "U" Assembly, Left (SA-874L) | JM0030136 |
| 2 | Grease Seal, 6-8 Ton (103953) | JM0026572 |
| 3 | Large Inner Bearing for 6-8 Ton (LM48548) (104579) | JM0019563 |
| 4 | G25 Hub with Races, Studs and Nuts, 7-8 Ton (105218) | JM0026566 |
| 5 | Small Outer Cone for 6-10 Ton (LM67048) | JM0019564 |
| 6 | 3/4"-16 Gr2 Castle Hex Nut | JM0002130 |
| 7 | Dust Cap, 6-10 Ton (103969) | JM0026567 |
| 8 | Large Cup for 6-8 Ton (LM48510) (104580) | JM0026565 |
| 9 | Wheel Stud for Hub, 6-8 Ton (1/2"-20 x 1-7/8") (4187) | JM0019559 |
| 10 | 1/2"-20 Lug Nut, 6-8 Ton (5552) | JM0003062 |
| 11 | Small Cup for 6-10 Ton (LM67010) (200500) | JM0026564 |
| 12 | 3/4" USS Z Flat Washer | JM0010006 |
| 13 | 5/32" x 1-1/2" Cotter Pin | JM0014348 |
| 14 | 1-3/4" Spindle & "U" Assembly, Right (SA-874R) | JM0030141 |
| 15 | ST215-75D14 Carlisle Sport Trail Tire | JM0019529 |
| 15 | 15" Tire ST215-75E15 (Carlisle) | JM0030451 |
| 16 | 14" x 6" - 6 Hole Wheel Rim | JM0019535 |
| 16 | 15" x 6" Wheel 6 Hole | JM0030449 |
| 17 | ST215-75D14 Carlisle Sport Trail Tire and 14x6 - 6 Hole Wheel Rim | JM0019536 |
| 17 | 15" Wheel & Tire Assembly ST215-75E15 6 Bolt (Carlisle) | JM0030452 |

Main Frame & Bars

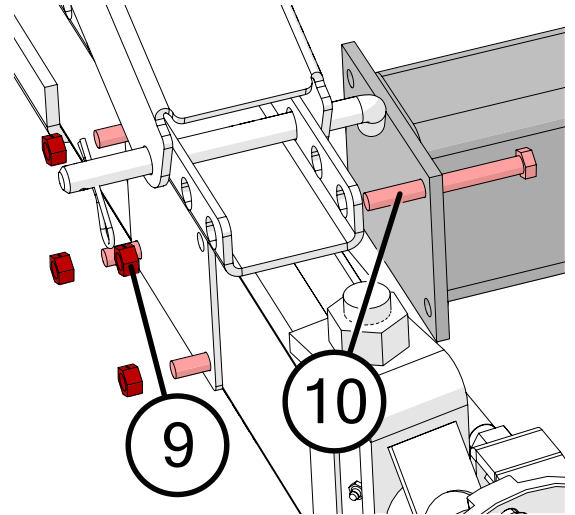
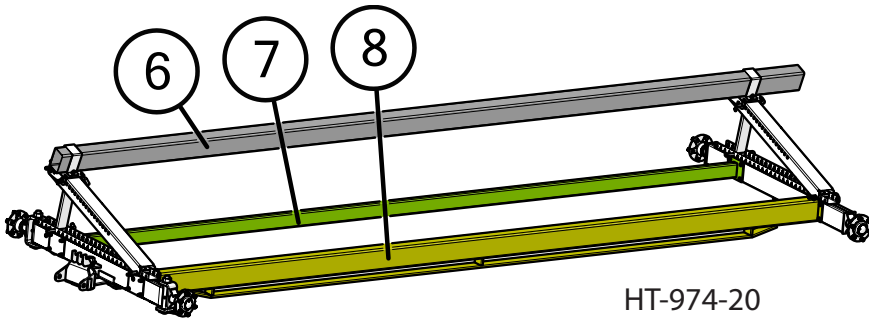
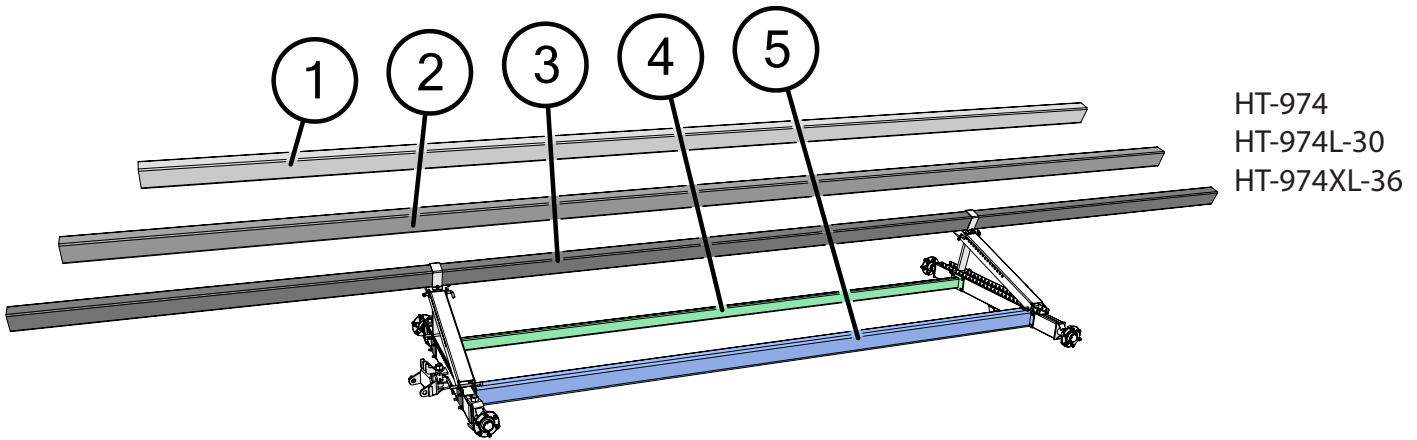

| | Description | Part No. |
|----|--|-----------|
| 1 | 4" x 6" x 25' Upper Bar (UB-874S) | JM0030203 |
| 2 | 4" x 6" x 30' Upper Bar (UB-874SXL) | JM0030201 |
| 3 | 4" x 6" x 36' Upper Bar (UB-874SXL-36) | JM0030205 |
| 4 | 2" x 4" x 152" Small Lower Bar (SLB-874) | JM0030175 |
| 4 | 2" x 4" x 194" Small Lower Bar (HT-874XL) | JM0030197 |
| 5 | 4" x 6" x 152" Large Lower Bar Weldment (LLB-874) | JM0030179 |
| 5 | 4" x 6" x 194" Large Lower Bar Weldment (LLB-874XL) | JM0030188 |
| 6 | 4" x 6" x 20' Upper Bar (HT-974) | JM0045427 |
| 7 | 2" x 4" x 216" Small Lower Bar Weldment (HT-974) | JM0045430 |
| 8 | 4" x 6" x 216" Large Lower Bar Weldment Trussed (HT-974) | JM0044987 |
| 9 | 1/2"-13 Gr2 Z Centerlock Hex Nut | JM0001511 |
| 10 | 1/2"-13 x 4-1/2" Gr5 Z Hex Bolt | JM0008548 |

Tongue Assembly

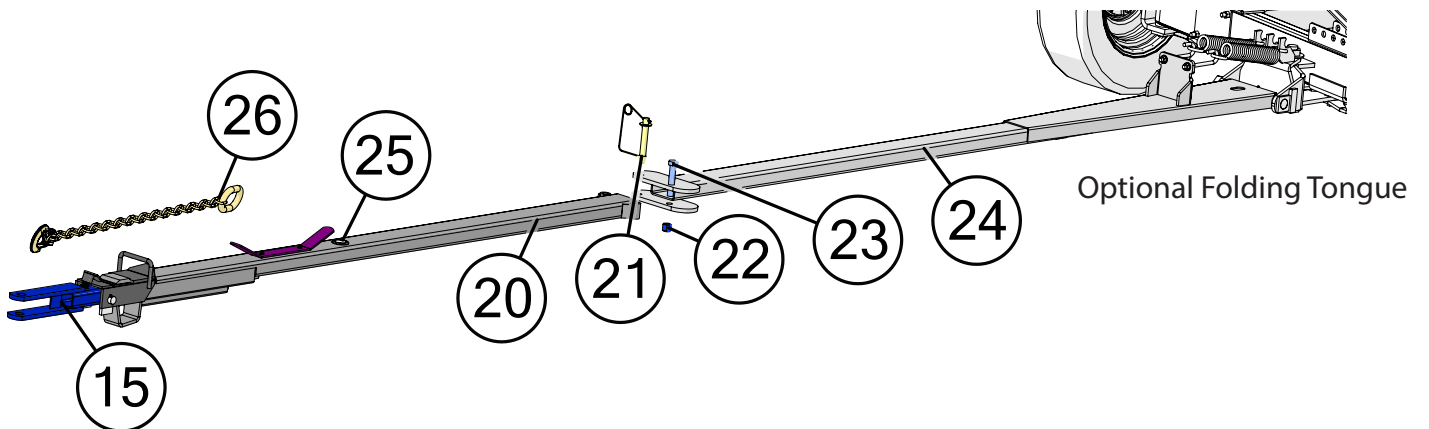
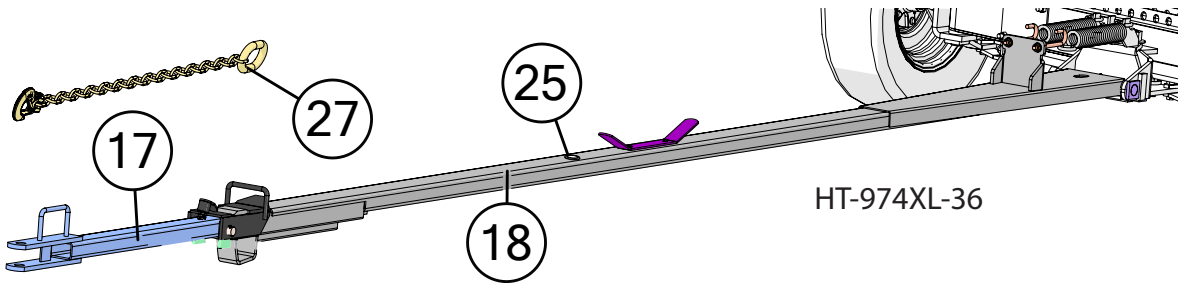
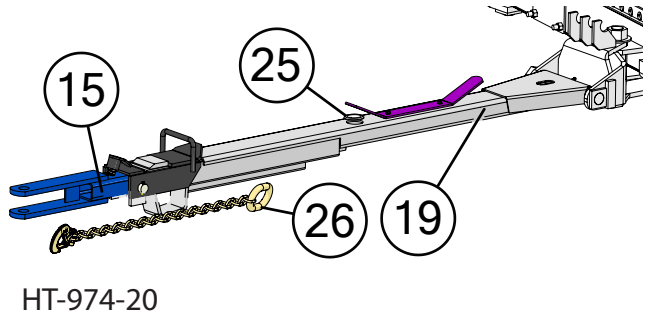
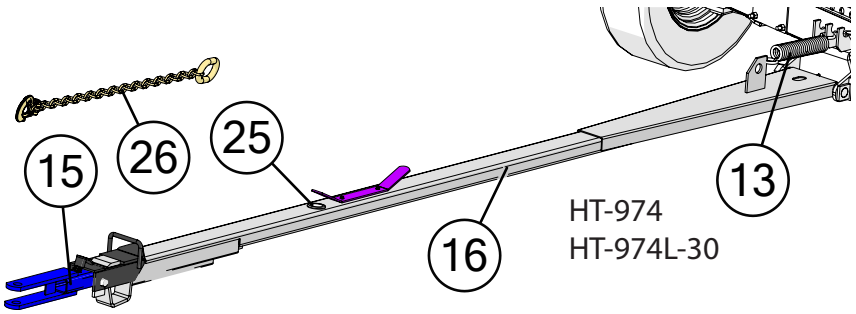
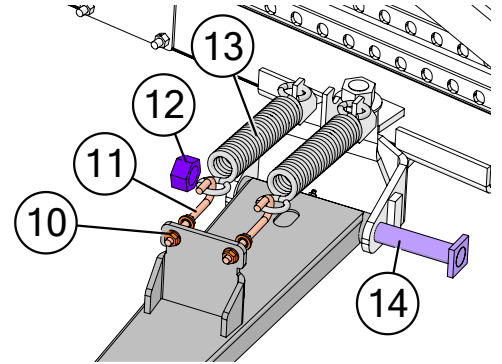
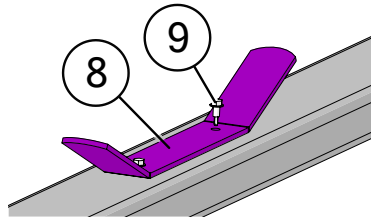
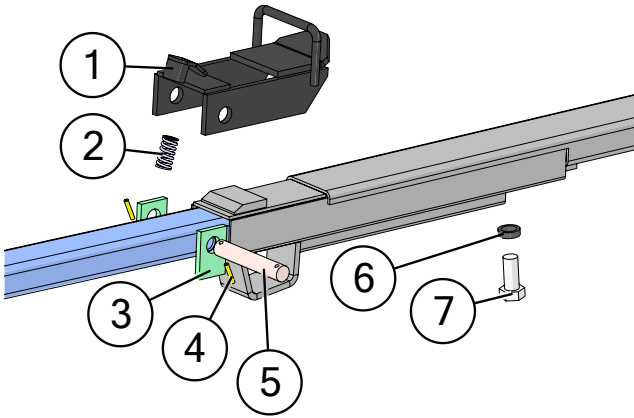

Tongue Assembly

| | Description | Part No. |
|----|---|-----------|
| 1 | Tongue Latch (Flapper Weldment) 10 Ton | JM0003033 |
| 2 | Compression Spring (1" x 1-3/4") for Door Assembly & Tongue Latch | JM0001688 |
| 3 | Spacer Blocks, 2-1/2", 6-15 Ton (SB-212) | JM0003032 |
| 4 | 1/4" x 1-3/8" Roll Pin | JM0009896 |
| 5 | 1" x 5-3/4" Flapper Pivot Shaft (LS-610) | JM0027732 |
| 6 | Tongue Stop Bolt Ring | JM0001649 |
| 7 | 7/8"-9 x 2" Gr5 Z Hex Bolt | JM0002108 |
| 8 | Wire Harness Storage Bracket (WHB-1) | JM0001438 |
| 9 | 1/4" x 3/4" Self Tapping Screw | JM0001570 |
| 10 | 1/2"-13 Gr5 Z SF Hex Nut | JM0002153 |
| 11 | 1/2"-13 x 6" Gr5 Z J-Bolt | JM0002168 |
| 12 | 1-1/4"-7 Gr2 Z Hex Nut | JM0001700 |
| 13 | Large Tongue Spring 3/8" x 1-3/4" x 12-1/2" (GDP) TS-615H | JM0014200 |
| 14 | 1-1/4" x 11-3/4" Tongue Bolt (6-10 Ton Horizontal) | JM0027667 |
| 15 | Short Inner Tongue 40" (Header Transport) | JM0001683 |
| 16 | 12' Outer Tongue Weldment (OT-HT974) | JM0030108 |
| 16 | 14'7" Outer Tongue Weldment 1 Spring (OT-HT974L) | JM0030106 |
| 17 | Long Inner Tongue 65" (Header Transport) | JM0030165 |
| 18 | 14'7" Outer Tongue Weldment 2 Springs (OT-HT974XL) | JM0030160 |
| 19 | 59" Outer Tongue Weldment (974-16, 974-20, 4WS-HD) | JM0046959 |
| 20 | HT-974 Folding Tongue Front Half | JM0075914 |
| 21 | 3/4" x 4" Lynch Pin | JM0075930 |
| 22 | 3/4"-10 Gr2 Z Nylon Locking Hex Nut | JM0026756 |
| 23 | 3/4"-10 x 4" Gr5 Z Hex Bolt (344B) | JM0009863 |
| 24 | HT-974 Folding Tongue Back Half | JM0075909 |
| 25 | 1-1/2" ID x 3/8" Wall GW x 1-3/4" GD Rubber Grommet (GR-134) | JM0000830 |
| 26 | 7mm P-7 49" O.A.L. 12,600# Safety Chain | JM0078442 |
| 27 | Safety Chain 74" OAL 12,600# | JM0087076 |

Header Mounts and Straps

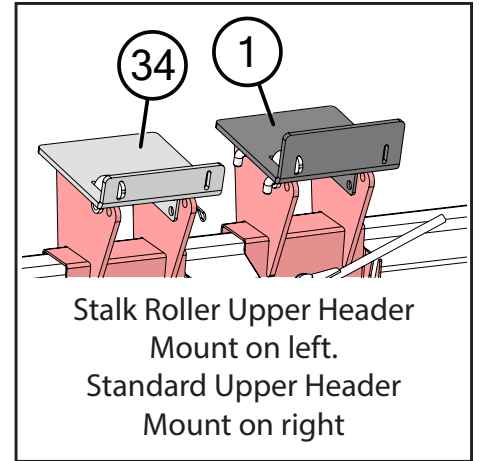
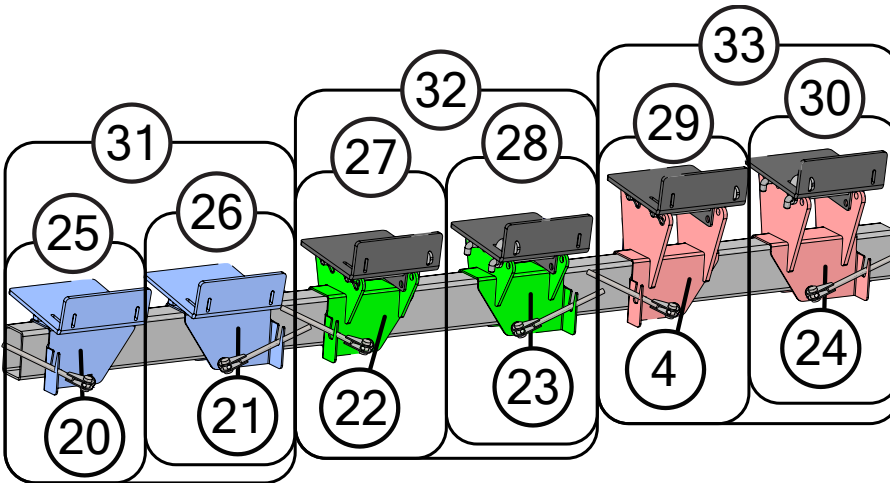
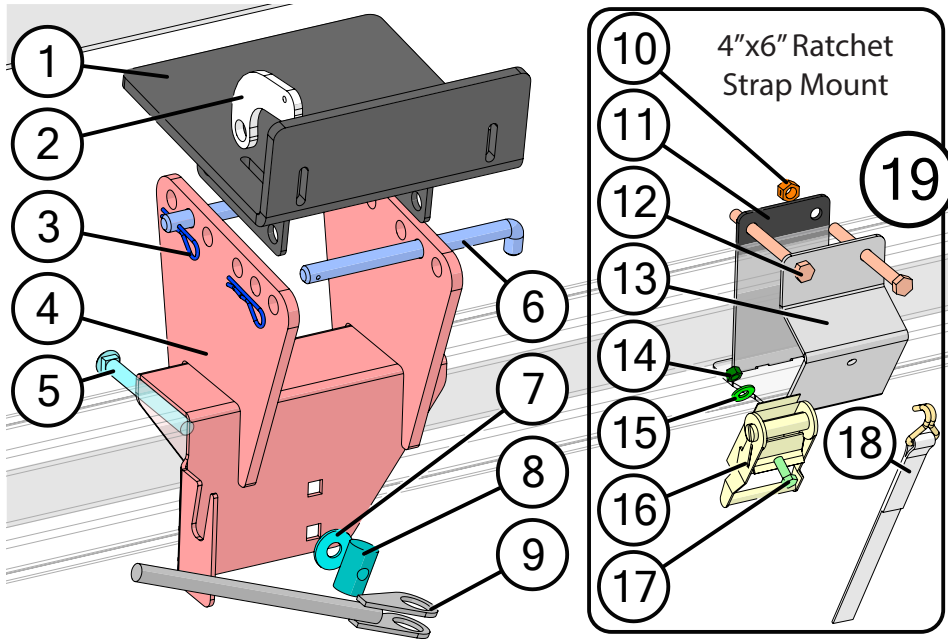

Header Mounts and Straps

| Description | | Part No. |
|-------------|--|-----------|
| 1 | Upper Header Wagon Mount | JM0014351 |
| 2 | Removable Header Stop Gusset | JM0003075 |
| 3 | 3/16" x 2-1/2" Hair Clip Pin (316HP) | JM0001657 |
| 4 | High Profile Bottom Mount Weldment 4" x 6" (Front) | JM0032573 |
| 5 | 5/8"-11 x 6-1/2" Gr5 Z Carriage Bolt | JM0001651 |
| 6 | 3/4" L Pin (10-9/32" Length) | JM0003076 |
| 7 | 5/8" USS Flat Washer | JM0003073 |
| 8 | Header Saddle Mount Bolt (Coupler) | JM0001653 |
| 9 | Clamp Handle Weldment (CHA2) | JM0001656 |
| 10 | 1/2"-13 Gr2 Z Centerlock Hex Nut | JM0001511 |
| 11 | 60 Degree Ratchet Strap Bracket Back Plate for 4" x 6" Tube | JM0044977 |
| 12 | 1/2"-13 x 5" Gr5 Z Hex Bolt | JM0001594 |
| 13 | 60 Degree Ratchet Strap Bracket Front Plate for 4" x 6" Tube | JM0044978 |
| 14 | 3/8"-16 Gr2 Z Centerlock Hex Nut | JM0001512 |
| 15 | 3/8" USS Flat Washer | JM0003061 |
| 16 | 2" Tie-Down Ratchet (10,000 lb) (RA-1) | JM0003084 |
| 17 | 3/8"-16 x 1" Gr8 YZ Hex Bolt | JM0001485 |
| 18 | 2" Wide x 60" Tie Down Strap with Double J Hook Sewn In (TDS-1) | JM0029979 |
| 19 | 60 Degree Two Piece Bracket with Ratchet Strap Assembly | JM0044980 |
| 20 | Extra Low Profile Mount 4" x 6" Saddle (Front) | JM0046210 |
| 21 | Extra Low Profile Mount 4" x 6" Saddle (Back) | JM0028948 |
| 22 | Low Profile Bottom Mount Weldment 4" x 6" (Front) | JM0037718 |
| 23 | Low Profile Bottom Mount Weldment 4" x 6" (Back) | JM0003072 |
| 24 | High Profile Bottom Mount Weldment 4" x 6" (Back) | JM0007140 |
| 25 | Extra Low Profile Header Mount Assembly for 4" x 6" Tube, Upper Mount 4-1/2" Lip (Front) | JM0058023 |
| 26 | Extra Low Profile Header Mount Assembly for 4" x 6" Tube, Upper Mount 4-1/2" Lip (Back) | JM0058024 |
| 27 | Header Mount Assembly 3-1/4" High Base for 4" x 6" Tube, Upper Mount 4-1/2" Lip (Front) | JM0058020 |
| 28 | Header Mount Assembly 3-1/4" High Base for 4" x 6" Tube, Upper Mount 4-1/2" Lip (Back) | JM0058021 |
| 29 | Header Mount Assembly 6-3/4" High Base for 4" x 6" Tube, Upper Mount 4-1/2" Lip (Front) | JM0058017 |
| 30 | Header Mount Assembly 6-3/4" High Base for 4" x 6" Tube, Upper Mount 4-1/2" Lip (Back) | JM0058018 |
| 31 | Extra Low Profile Header Mount Assembly for 4" x 6" Tube, Upper Mount 4-1/2" Lip (Set) | JM0058025 |
| 32 | Header Mount Assembly 3-1/4" High Base for 4" x 6" Tube, Upper Mount 4-1/2" Lip (Set) | JM0058022 |
| 33 | Header Mount Assembly 6-3/4" High Base for 4" x 6" Tube, Upper Mount 4-1/2" Lip (Set) | JM0058019 |
| 34 | Upper Header Wagon Mount with Short Lip | JM0054856 |

Upper Bar Mounts

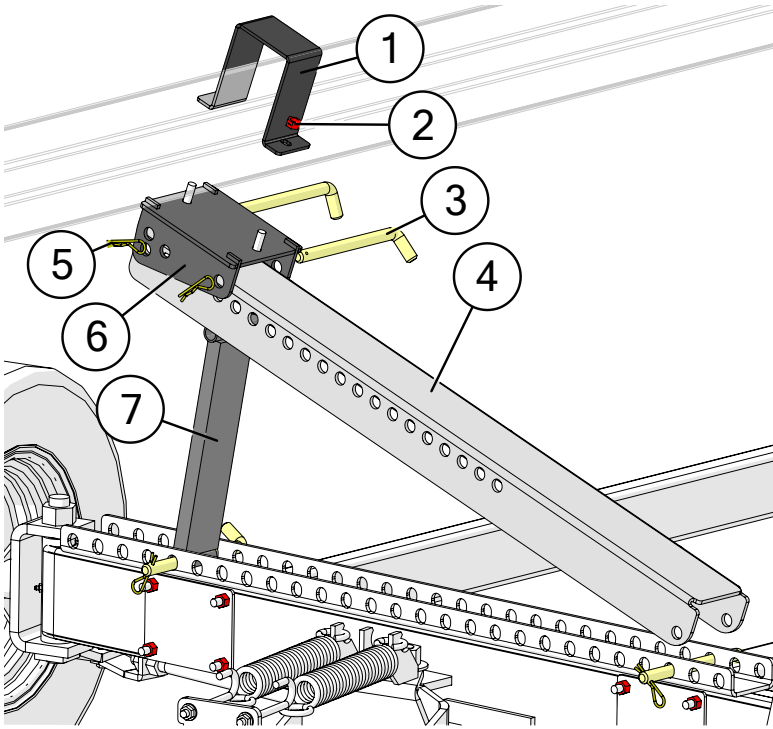

Stalk Roller Scissor Arm and Upper Bar Mount

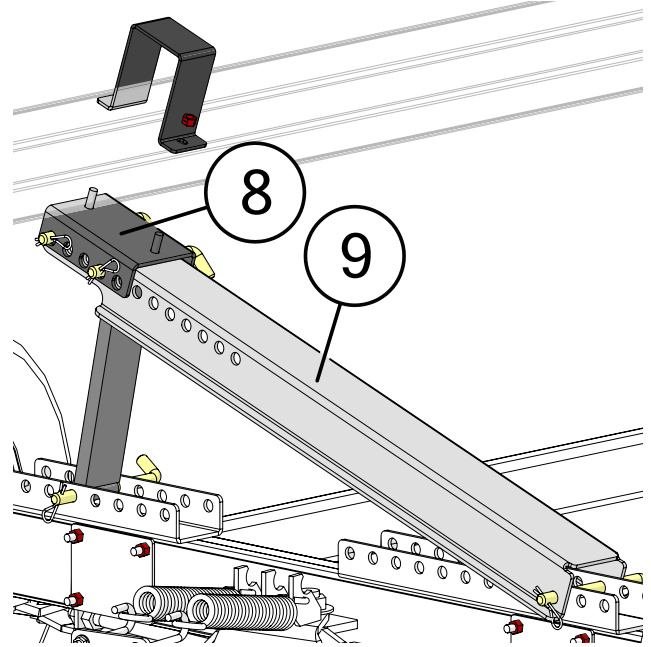

Standard Scissor Arm and Upper Bar Mount

| Description | | Part No. |
|-------------|---|-----------|
| 1 | Upper Bar Clamp (4x6) (UBC-2) | JM0028447 |
| 2 | 1/2"-13 Gr5 Z SF Hex Nut | JM0002153 |
| 3 | 3/4" x 8" Z L Pin (Header Wagon, c450) | JM0029738 |
| 4 | HT974 Scissor Arm (Stalk Roller Option) | JM0054841 |
| 5 | 3/16" x 2-1/2" Hair Clip Pin (316HP) | JM0001657 |
| 6 | HT974 Upper Bar Mount/Slide Mount with Tilt | JM0062925 |
| 7 | Upper Bar Support Arm (UBSA-3) | JM0003077 |
| 8 | Upper Bar Slide Mount (UBSM-3) | JM0015133 |
| 9 | Upper Bar Channel Mount 3/4" (UBCM-3) | JM0029588 |

Axle Weldments

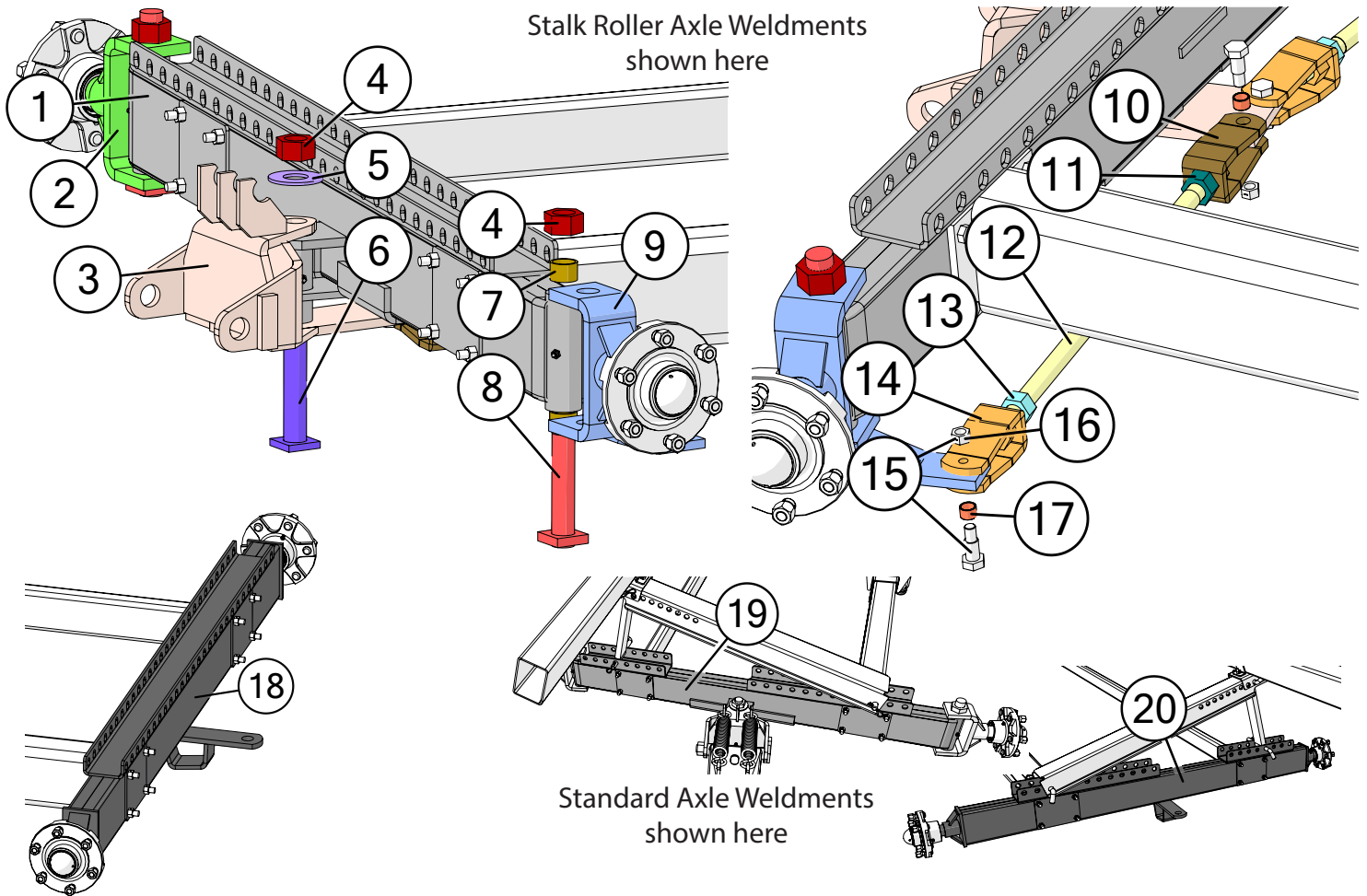

| | Description | Part No. |
|----|--|-----------|
| 1 | Front Axle, Less Hub, Spindle Assembly and Hitch For Stalk Rollers (HT) | JM0076273 |
| 2 | 1-3/4" Spindle & "U" Assembly, Right (SA-874R) | JM0030141 |
| 3 | Hitch Swivel Weldment 6-8 Ton (HT-974) (HW-68) | JM0030131 |
| 4 | 1-1/4"-12 Gr5 Z Hex Jam Nut | JM0002158 |
| 5 | 1-1/4" USS Flat Washer | JM0010112 |
| 6 | King Pin Vertical Hitch Bolt (1-1/4" x 7-3/4") 6-10 Ton (KP-610) | JM0027665 |
| 7 | 1-1/4" ID x 1-1/2" OD Bronze Bushing (1" Depth) | JM0002248 |
| 8 | Spindle Bolt 1-1/4" x 10-1/4" (SB-114) | JM0019324 |
| 9 | 1-3/4" Spindle & "U" Assembly, Left (SA-874L) | JM0030136 |
| 10 | 6-10 Ton Clevis Weldment (Left) (TRE-78L) | JM0003168 |
| 11 | 7/8"-14 Gr5 Z LH Hex Nut | JM0027686 |
| 12 | Tie Rod (7/8" x 24-1/2") (TR-78) | JM0030104 |
| 13 | 7/8"-14 Gr5 Z Hex Nut | JM0025714 |
| 14 | 6-10 Ton Clevis Weldment (Right) (TRE-78R) | JM0030149 |
| 15 | 5/8" Shoulder Dia x 1" Shoulder Length x 1/2"-13 Shoulder Bolt & Nut (SB-58) | JM0002408 |
| 16 | Nut for 5/8" Shoulder Bolt | JM0003185 |
| 17 | 5/8" ID x 3/4" OD x 1/2" Bronze Bushing (BB-58) | JM0003189 |
| 18 | Rear Axle, Less Hub Assemblies for Stalk Roller (HT) | JM0076274 |
| 19 | Front Axle, Less Hub, Spindle Assembly and Hitch (HT) (FA-974) | JM0030103 |
| 20 | Rear Axle, Less Hub Assemblies (HT) (RA-974) | JM0030097 |

Upper Bar Extension and Pivoting Lightbar

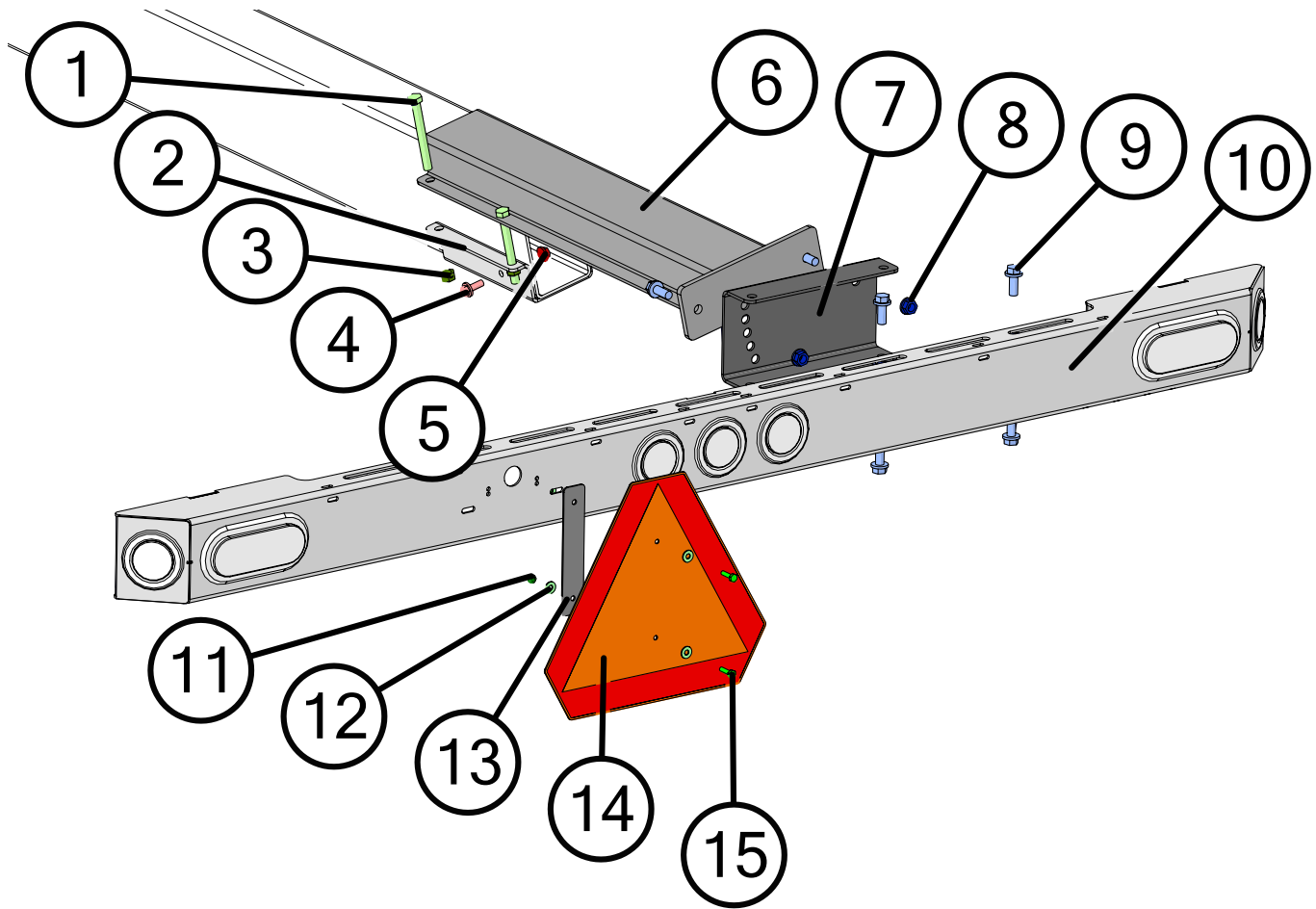

| | Description | Part No. |
|----|---|-----------|
| 1 | 1/2"-13 x 2" Gr5 Z Hex Bolt | JM0001593 |
| 2 | Short Light Bar Mount Clamp (9"L) | JM0061627 |
| 3 | 1/2"-13 Gr2 Z Centerlock Hex Nut | JM0001511 |
| 4 | 3/8"-16 x 1" Gr5 Z SF Hex Bolt | JM0002092 |
| 5 | 3/8"-16 Gr5 Z SF Hex Nut | JM0002152 |
| 6 | Header Transport Light Mount Extension Bracket (2 Hole) | JM0061609 |
| 7 | Header Transport Light Mount Adapter Bracket | JM0061613 |
| 8 | 1/2"-13 Gr5 Z SF Hex Nut | JM0002153 |
| 9 | 1/2"-13 x 1-1/4" Gr5 Z SF Hex Bolt | JM0010002 |
| 10 | Highspeed Header Transport Lightbar Weldment | JM0068907 |
| 11 | 1/4"-20 Gr2 Z Centerlock Hex Nut | JM0001505 |
| 12 | 1/4" ID, 3/4" OD Z Flat Washer | JM0003090 |
| 13 | SMV Bracket | JM0001645 |
| 14 | Slow Moving Vehicle Sign | JM0001616 |
| 15 | 1/4"-20 x 1" Gr5 Z Hex Bolt | JM0002095 |

Lights and Wiring for Pivoting Lightbar No Brakes

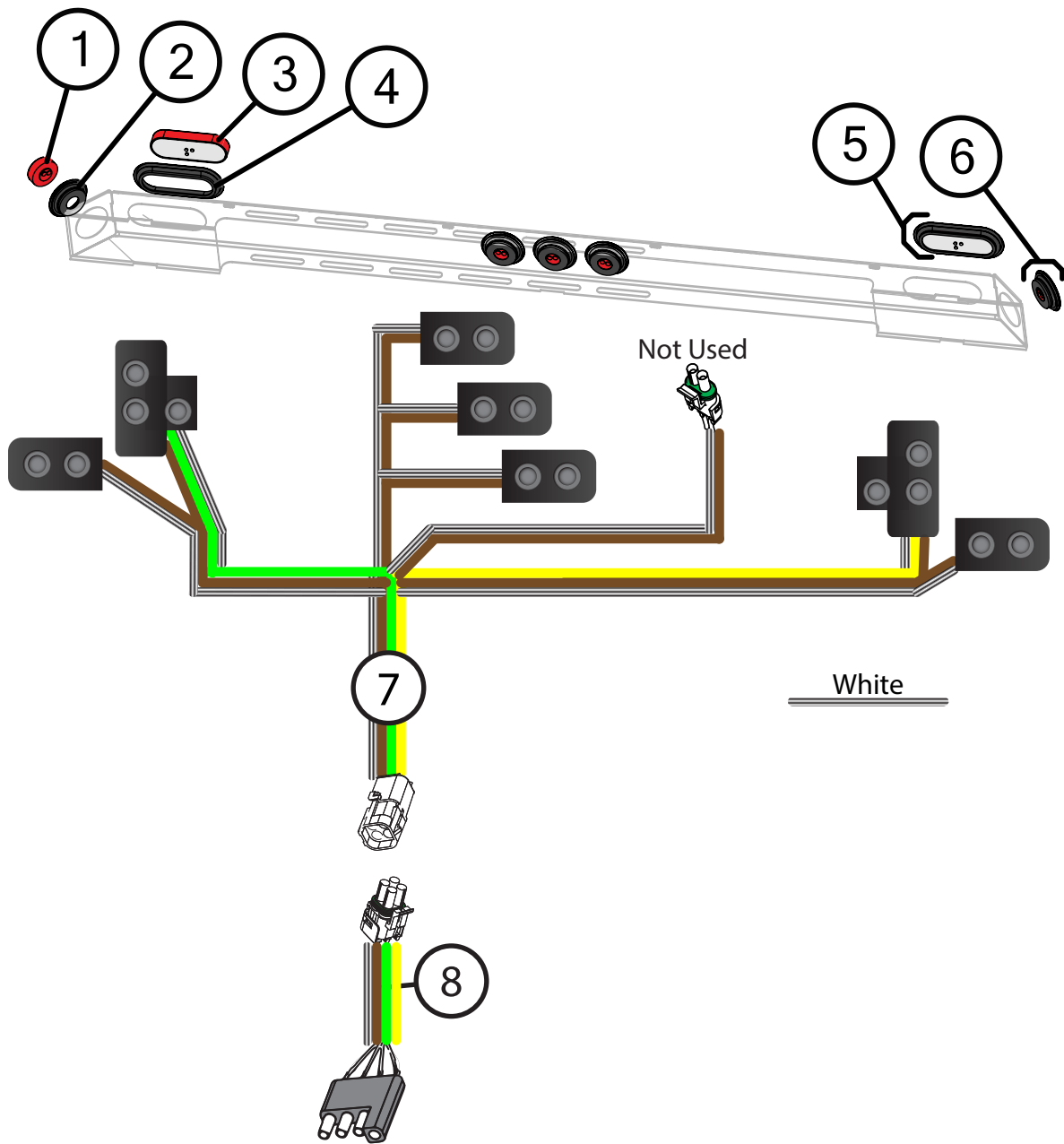

| | Description | Part No. |
|---|---|-----------|
| 1 | 2-1/2" Red Round LED Light/Reflector (RRLR1) | JM0001901 |
| 2 | Round Grommet for LED 2-1/2" Light/Reflector | JM0001902 |
| 3 | Red Oval Brake Light LED (BLSTOL1) | JM0007114 |
| 4 | Oval Grommet for Brake Light LED (OVLG1) | JM0001897 |
| 5 | Red Oval Brake Light LED Assembly (BLSTOA1) | JM0001903 |
| 6 | 2-1/2" Red Round LED Light/Reflector Assembly (RRLA1) | JM0001905 |
| 7 | Header Transport Light Bar Harness 2023 and Newer | JM0081268 |
| 8 | Main Harness, AG No Brakes (2024 & Newer) | JM0082290 |