



## Options to Fit Your Specific Needs!

We know that equipment performs best when it is tailored to fit your specific needs. With our many innovative options, we can customize your grain cart to fit a variety of field conditions and settings.



### True Lock Roll Tarps

#### Protect Your Crops From Changing Weather Conditions

Our easy locking roll tarp utilizes a tensioned roll tube and locking lip that maintains a tight seal without the need for tie down straps.

### Electronic Weigh Scale Systems

#### Check Your Yield As You Harvest

Accurate to within **ONE PERCENT**, electronic scales feature either a three point system for grain carts equipped with single flotation wheels or a five point system for carts equipped with tandem walking duals or tracks.

An optional printer gives you a print-out of each load for your records, while a Windows based Data Transfer System allows you to download and store a complete Excel chart summary for future reference.



### Longer Upper Auger Maximizes Unloading Height and Reach!

NEED TO MAXIMIZE REACH AND HEIGHT?

The upper auger can be lengthened to fit your specific unloading need!

Reach across ditches, fences or the tallest trucks and wagons easier with a 12" to 16" longer upper auger.



### Fully-Adjustable Axle and Rice Axle Options

The **Fully Adjustable** Axle option is available for row spacing outside the standard 120" - 144" or for scale carts with really wide flotation tires.



The **Rice Axle** option provides an **additional 6"** of ground clearance.

### Mobile Video Camera System

#### Dual Camera System with Color Monitor

**Base Package** – Features a 5.6" LCD Color Monitor with fixed camera. Additional cameras can be added for operators who demand greater visibility from behind the grain cart and want a view inside the semi-trailer while unloading.



### High Capacity Hydraulic Drive

Designed with a variety of motors (**high capacity, high torque, high speed**) to meet your specific need. Double supply and return lines for optimum performance.



## Patented Front Folding Auger Carts

### DIMENSIONS

	525-14W	620-14	750-16 750-18	875-18
A	1'-5"	1'-5"	1'-7"	1'-7"
B	12'-10"	12'-10"	12'-9"	13'-6"
C	5'-11"	5'-11"	6'-3"	6'-4"
D	12'-0"	13'-2"	14'-0"	16'-0"
E	18'-1"	18'-10"	19'-1"	20'-11"
F*	12'-9" / 13'-9"	12'-9" / 13'-9"	12'-9" / 13'-9"	12'-9" / 13'-9"
G*	7'-3" / 8'-3"	7'-3" / 8'-3"	7'-3" / 8'-3"	7'-3" / 8'-3"
H	10'-4"	11'-4"	11'-3"	11'-6"
I	8'-7"	8'-7"	10'-4"	10'-6"
J	1'-2"	1'-6"	1'-5"	1'-5"
K	1'-7"	2'-0"	2'-7"	2'-0"
L	10'-0" / 12'-0"	10'-0" / 12'-0"	10'-0" / 12'-0"	10'-0" / 12'-0"
M	12'-0"***	12'-0"***	12'-6"****	12'-6"****
N	10'-0"	11'-10"	11'-9"	11'-9"
O	9'-10"	10'-9"	10'-10"	10'-11"

\* Greater auger height and reach obtained with optional longer upper auger.  
\*\* Measured with 24.5x32 tires at 120" row spacing.  
\*\*\* Measured with 30.5x32 tires at 120" row spacing.

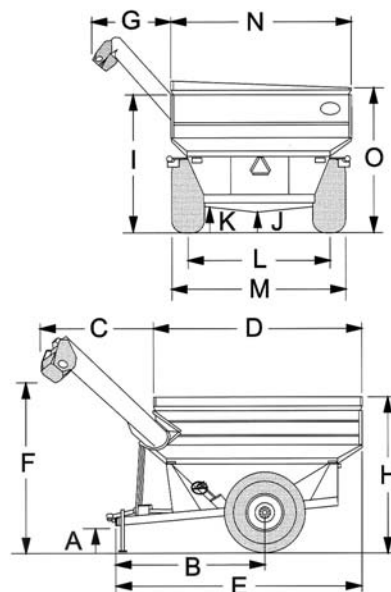

### SPECIFICATIONS

	525-14W	620-14	750-16 750-18	875-18
Capacity	525 bushels	620 bushels	750 bushels	875 bushels
Auger, One Vertical	14" diameter	14" diameter	16" or 18" diameter	18" diameter
Unload Time	3.2 minutes	3.7 minutes	3.5 minutes or 1.7 minutes	2.0 minutes
Wheels	20x26, 21x32, 27x32 or 18x42	21x32, 27x32 or 18x42	21x32, 27x32, 18x42, 16x46 or 25x36	21x32, 27x32, 31x32 or 25x36
Hubs	10 bolt	10 bolt	10 bolt	10 bolt
Spindles	4 1/2" diameter	4 1/2" diameter	4 1/2" diameter	4 1/2" diameter
PTO	1,000 rpm	1,000 rpm	1,000 rpm	1,000 rpm
Tires	23.1x26, 24.5x32, 30.5x32 or 20.8x42	24.5x32, 30.5x32 or 20.8x42	24.5x32, 30.5x32, 20.8x42, 18.4x46 or 66x43.00	24.5x32, 30.5x32, 35.5x32, 900/60R32 or 66x43.00
Tongue Weight				
Empty	950 lbs.	1,000 lbs.	1,150 lbs.	1,275 lbs.
Loaded	1,950 lbs.	2,100 lbs.	2,850 lbs.	3,800 lbs.
Total Weight (approx.)	6,300 lbs.	6,950 lbs.	7,650 / 7,900 lbs.	9,300 lbs.
Construction				
Hopper	12 GA Steel	12 GA Steel	12 GA Steel	12 GA Steel
Undercarriage	8" x 4" x 3/16" Tubing	8" x 4" x 3/16" Tubing	8" x 4" x 1/4" Tubing	8" x 4" x 5/16" Tubing
Axle (V-Truss)	5" x 5" x 1/2" Tubing	5" x 5" x 1/2" Tubing	5" x 5" x 1/2" Tubing	5" x 5" x 1/2" Tubing



## Patented Front Folding Auger Carts

525, 620, 750 or 875 Bushel Capacity  
14", 16" or 18" Diameter Unloading Auger



### Models

- 525-14W
- 620-14
- 750-16, 750-18
- 875-18

### Grain Cart Features:

- Patented Front-Folding Auger Design
- 525, 620, 750 or 875 Bushel Capacity
- 14", 16" or 18" Diameter Auger
- 100% Visibility of Auger While Unloading AND During Folding Sequence
- Excellent Cleanout



### Customer Responses

Unloads very fast and fills our semi in one trip which gets the truck back on the road quickly. This is helpful versus what we used to have.

#### Cross Creek Farms - Brimfield, IL

Love these carts. They made our best harvest ever go very good! No problems at all. Very easy for everyone...tractor, truck and combine operators all enjoyed them!

#### Ag Plus Developments Inc. - Tallula, IL



### J. & M. Mfg. Co., Inc.

P.O. Box 547 Ft. Recovery, OH 45846

Ph: (419) 375-2376 Fax: (419) 375-2708

www.jm-inc.com

### GUARANTEE

J. & M. MANUFACTURING CO. guarantees against any faulty construction or materials for a period of ONE year. We reserve the right to inspect and decide whether material or construction was faulty or whether abuse or accident voids our guarantee.

Specifications are subject to change without notice or obligation.  
© Registered Trademark of J. & M. Mfg., Co. Inc.

Do you want to learn more about the advantages of our patented grain carts?  
Visit "J&M University" at [www.jm-inc.com](http://www.jm-inc.com)



## What Makes J&M Better? Value-Added Design

While all grain carts share basic components (like gearboxes and power take-off shafts) and basic features (like folding augers and discharge spouts), not all grain carts utilize these basic components and features in a design that maximizes its performance and usability. J&M grain carts offer many design features that create a level of performance that is unmatched throughout the industry.

It's what we call **VALUE ADDED DESIGN**.



### Patented Hydraulic Flow Control Spout

Easily corrects auger position on too close or too far away approaches, all from inside the tractor cab! Standard equipment on all auger carts.

### Patented Auger System

#### Only J&M's Patented Front Folding Auger Design Offers Total Visibility

Designed with the operator in mind, the upper auger is positioned in the corner and extends toward the tractor cab, creating a **closer, clearer view** when unloading grain.

The patented Front-Folding Auger features a unique design that provides **100% visibility during unloading AND equally important 100% visibility during the folding sequence.**

Other carts try to use words such as "corner-like" and "100% visibility" to appear the same, but they don't compare.

### Excellent Cleanout

#### Unique Hopper Design Is Key To Excellent Cleanout In High Moisture Grain

J&M has built a solid reputation for excellent clean-out...even in high moisture grain. The secret is in the tank design. J&M grain carts feature a **grain tank with different front and rear slopes**. This allows the grain to move downward at different speeds, creating a **boiling effect**. This design prevents bridging in high moisture crops.

Other carts that have front and rear tank walls at the same angle move grain at the same speed into the auger, which fails to 'pull' grain into the sump...allowing more grain to hang up.

Approximate material left in the tank is 1 1/2 gallons!



## Patented Front-Folding Corner Auger Carts

## The Most Dependable and Easiest to Operate Carts



Models  
875-18



Models  
750-18  
750-16



Model  
620-14



Model  
525-14W

### The Most Dependable Cart In The Field

Harvest season rarely goes according to plan, but nothing is more dependable when it comes to getting the job done than the patented line of J&M Front-Folding Corner Auger Carts.

The single auger design, rugged tank and undercarriage construction has been helping farmers hold more, travel faster and unload quicker for three decades, keeping them on the go even in the most extreme conditions.

So while other factors can alter your plans, you can always depend on the reliable J&M grain cart to get you through the most demanding harvest with ease.



### Easy For Everyone To Operate

The patented auger design puts the unloading spout next to the tractor cab, making it easier for the operator to see what's going on while unloading. The Hydraulic Flow Control Spout makes topping off the trailer quick and easy for even the most novice of operators. Since the auger stores along the front of the grain cart and not the side, the operator can clearly see the entire folding sequence. No upper auger indicators are required. **No other grain cart offers this level of simplicity for the operator.**



All J&M Grain Carts feature a graphite coated interior with primer coating and durable poly-urethane exterior for maximum gloss. Seams are siliconed sealed to prevent rust and corrosion. Available in Red, Green, Blue or Yellow to match your equipment.

### Balanced Tongue Weight

#### Tank Design Allows Better Axle Placement For Balanced Tongue Weight

The weight distribution of J&M grain carts are superb compared to competitive carts. Due to different front and rear slopes in the tank design, the undercarriage axle can be positioned to produce a properly **balanced tongue weight**, reducing the stress and upgrade costs on your tractor draw bar.

J&M grain carts offer a much greater advantage to you with **significantly less tongue weight**, providing reassurance of less wear and tear on your tractor and cart.

### Heavy Duty Driveline

#### Protection That Ensures Performance

J&M grain carts use a powerful take-off shaft with a proven slip clutch. This system utilizes friction pads to protect the drive system and **reduce downtime and maintenance costs.**

Grain carts equipped with a 14" or 16" dia. unloading auger feature a self-adjusting slip clutch with an internal bell spring washer.

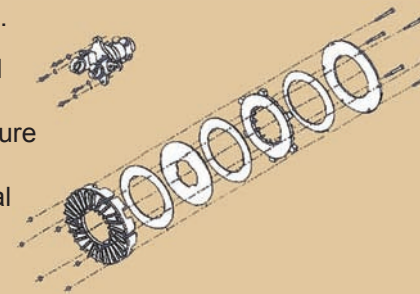

### Computer Balanced Auger

#### Super-Edge Flighting Balanced to Within One Ounce

All J&M grain carts feature thick flighting with patented Super-Edge that puts more material where it is needed, on the outer edge. In addition, we **reinforce the flighting at critical wear points** to increase flighting life and durability.

**All augers are balanced to within ONE OUNCE.** Precision manufacturing ensures a quiet running system that **extends overall auger life and performance** by reducing vibration to the drive system.

